





Lysander House, Union Way, London NW10 6FJ
£425,000 - Leasehold



PROPERTY DESCRIPTION

Discover this exquisite two-bedroom, two-bathroom modern apartment situated on the prestigious ninth floor, offering magnificent panoramic views that extend beyond the horizon. With a private balcony perfectly positioned to enjoy these stunning vistas, this property seamlessly combines contemporary design with luxurious living. Featuring a spacious reception room ideal for both relaxing and entertaining, the apartment benefits from a sought-after no upper chain status, ensuring a smooth and hassle-free purchase. Additional perks include a 24-hour concierge service in the reception area, providing residents with enhanced security and convenience every day.

Located in a vibrant and well-connected area, this apartment offers more than just a home—it provides a lifestyle. The neighbourhood is renowned for its excellent transport links, local amenities, and a variety of cafes, restaurants, and shops just moments away. Whether commuting to work or exploring leisure activities, everything you need is within easy reach. Green spaces and recreational facilities nearby offer opportunities for outdoor enjoyment, while cultural and entertainment venues enrich the living experience. This prime setting perfectly complements the modern lifestyle offered by the apartment.

The entrance leads into a welcoming hallway that provides access to all main rooms. The expansive reception room boasts ample natural light, creating a warm and inviting atmosphere to unwind or host guests. From here, step out onto the private balcony where you can savour the breathtaking views, making it an ideal spot for morning coffee or evening relaxation. The sleek, contemporary kitchen is efficiently designed with modern fittings and integrated appliances, catering effortlessly to everyday cooking needs.

The apartment features two well-proportioned bedrooms, each designed with comfort in mind. The master bedroom includes an en-suite bathroom fitted with high-quality fixtures, offering a private retreat within the home. The second bedroom is equally spacious, perfect for guests, a home office, or a growing family. A guest bathroom completes the accommodation, equipped with modern amenities and tasteful finishes, ensuring convenience for residents and visitors alike.

Additional highlights of this property include secure entry, ample storage space, and the peace of mind brought by a professional concierge available around the clock. Living on the ninth floor not only guarantees spectacular views but also enhances privacy and tranquillity away from street-level noise. This is a rare opportunity to acquire a stylish, move-in ready apartment that combines luxury, practicality, and an unbeatable location. Don't miss the chance to make this stunning residence your new home.

POINTS OF INTEREST

- TWO BEDROOMS
- TWO BATHROOMS
- PRIVATE BALCONY
- MODERN APARTMENT
- NINTH FLOOR
- STUNNING VIEWS
- NO UPPER CHAIN
- CONCIERGE IN RECEPTION

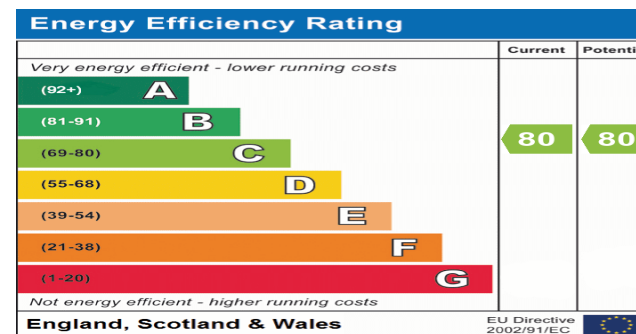

Union Way, NW10 6FJ

Approx Gross Internal Area = 72.78 sq m / 783 sq ft

Balcony = 8.55 sq m / 92 sq ft

Total = 81.33 sq m / 875 sq ft

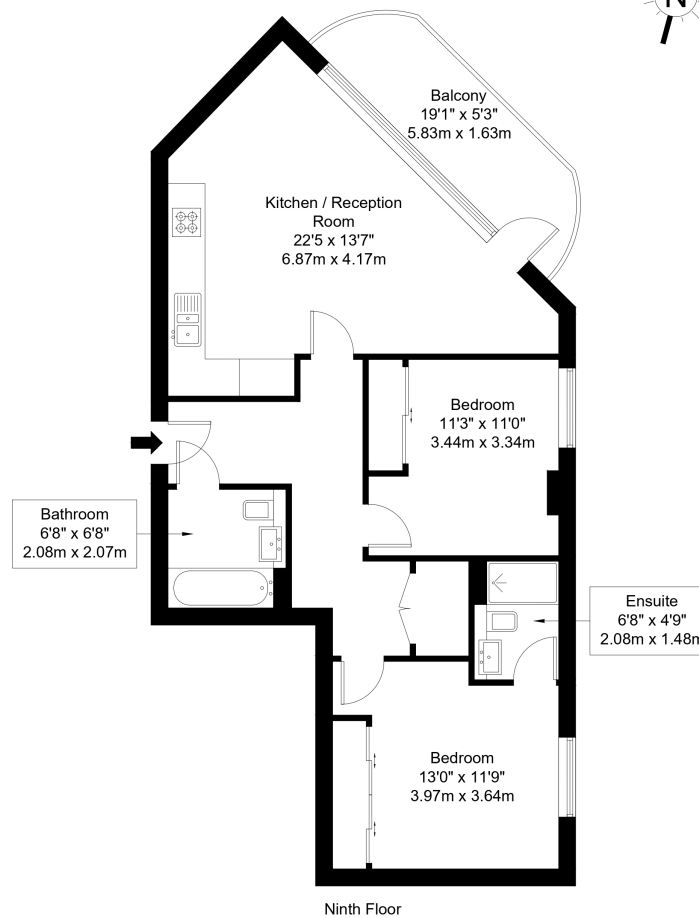
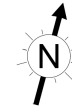

Ref :

Copyright **BLEU
PLAN**

The Floor plan is not to scale and measurements and areas shown are approximate and therefore should be used for illustrative purposes only. The plan has been prepared in accordance with the RICS code of Measuring Practice and whilst we have confidence in the information produced it must not be relied on. Maximum lengths and widths are represented on the floor plan. If there is any aspect of particular importance, you should carry out or commission your own inspection of the property.

Copyright @ BLEUPLAN