

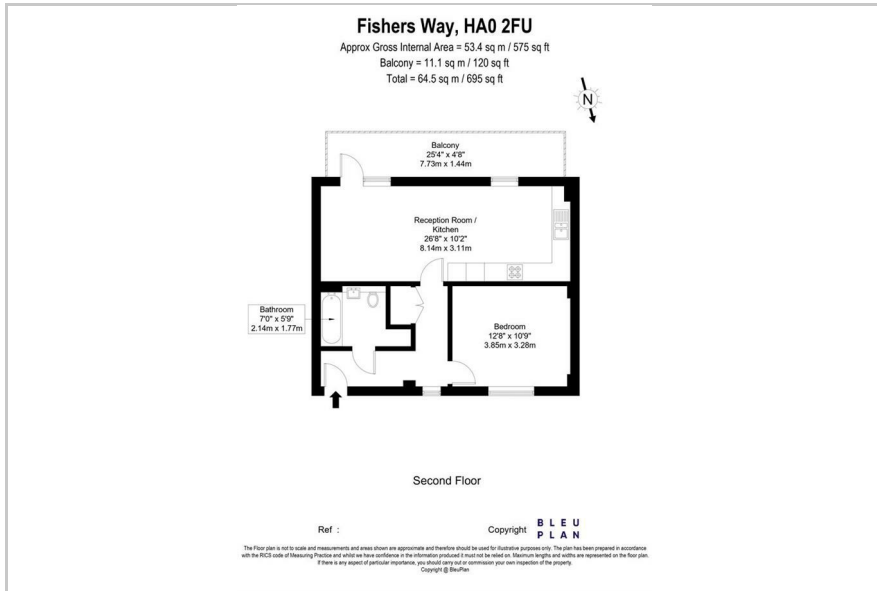

Fishers Way, Wembley, HA0 2FU
£1,700 Per Month

 1  1  1  B

Floor Plan



Area Map



These particulars, whilst believed to be accurate are set out as a general outline only for guidance and do not constitute any part of an offer or contract. Intending purchasers should not rely on them as statements of representation of fact, but must satisfy themselves by inspection or otherwise as to their accuracy. No person in this firm's employment has the authority to make or give any representation or warranty in respect of the property.

Accommodation

- FANTASTIC SECOND FLOOR FLAT 1 BEDROOM APARTMENT
- SECURE GATED ENTRY POINT TO COMMUNAL GARDEN & FLAT
- EXCELLENT CONDITION THROUGHOUT
- LARGE FULL LENGTH BALCONY WITH ACCESS FROM LOUNGE
- PARKING PERMIT (£113.00 PA) - FIRST COME FIRST SERVE BASIS
- COMMUNAL PLAY AREA SOLELY FOR RESIDENTS
- EPC RATING - B / COUNCIL TAX BAND - C



Viewing

Please contact our Daniels, Sudbury Office on 020 8904 4888 if you wish to arrange a viewing appointment for this property or require further information.

Energy Efficiency Graph

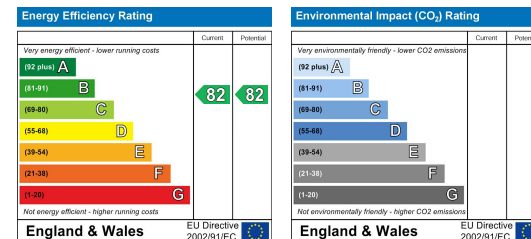

Sudbury

35 Court Parade, Sudbury
 Middlesex HA0 3HS

Sales 020 8904 4888
 Lettings 020 8452 7999
 E sudbury@danielsestateagents.co.uk

Wembley

438 High Road, Wembley
 Middlesex HA9 6AH

Sales 020 8900 2811
 Lettings 020 8452 7999
 E wembley@danielsestateagents.co.uk

Neasden

352 Neasden Lane, Neasden
 London NW10 0AD

Sales 020 8452 7000
 Lettings 020 8452 7999
 E neasden@danielsestateagents.co.uk

Willesden Green

33 Walm Lane, Willesden Green
 London NW2 5SH

Sales 020 8452 7000
 Lettings 020 8452 7999
 E willesdengreen@danielsestateagents.co.uk

Kensal Rise

77 Chamberlayne Road, Kensal Rise
 London NW10 3ND

Sales 020 8969 5999
 Lettings 020 8969 5999
 E kensalrise@danielsestateagents.co.uk