

**Sales:** 020 8452 7000  
**Lettings:** 020 8900 2121  
**Email:** wg@danielsestateagents.co.uk  
www.danielsestateagents.co.uk

**daniels**  
danielsestateagents.co.uk



**Minet Avenue**

Harlesden, London, NW10 8AR

**£550,000**



Floor Plan

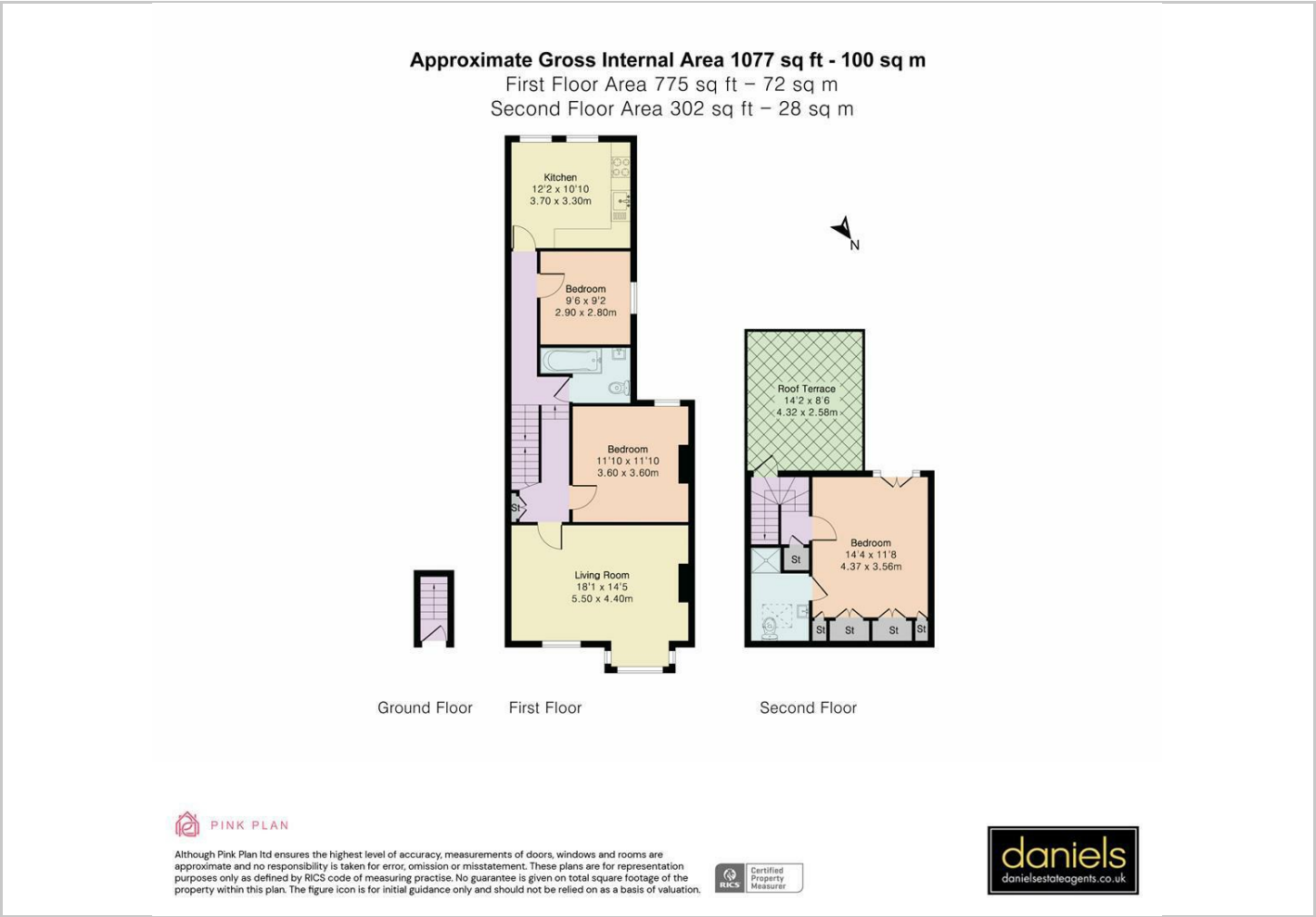

- Immaculately Presented ■ Master Bedroom with En-Suite
- Roof Terrace ■ 100 Sq. M - 1077 Sq. Ft
- 0.4 Miles to Willesden Junction Station (Zone 2) ■ Kitchen-Diner

Energy Efficiency Graph

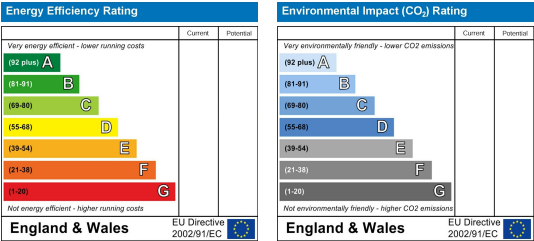

These particulars, whilst believed to be accurate are set out as a general outline only for guidance and do not constitute any part of an offer or contract. Intending purchasers should not rely on them as statements of representation of fact, but must satisfy themselves by inspection or otherwise as to their accuracy. No person in this firms employment has the authority to make or give any representation or warranty in respect of the property.

Sudbury

35 Court Parade, Sudbury  
Middlesex HA0 3HS  
Sales 020 8904 4888  
Lettings 020 8452 7999  
E sudbury@danielsestateagents.co.uk

Wembley

438 High Road, Wembley  
Middlesex HA9 6AH  
Sales 020 8900 2811  
Lettings 020 8452 7999  
E wembley@danielsestateagents.co.uk

Neasden

352 Neasden Lane, Neasden  
London NW10 0AD  
Sales 020 8452 7000  
Lettings 020 8452 7999  
E neasden@danielsestateagents.co.uk

Willessden Green

33 Walm Lane, Willessden Green  
London NW2 5SH  
Sales 020 8452 7000  
Lettings 020 8452 7999  
E willessdengreen@danielsestateagents.co.uk

Kensal Rise

77 Chamberlayne Road, Kensal Rise  
London NW10 3ND  
Sales 020 8969 5999  
Lettings 020 8969 5999  
E kensalrise@danielsestateagents.co.uk