



daniels
danielsestateagents.co.uk

daniels
danielsestateagents.co.uk



Copland Court, Durham Wharf Drive, Brentford, Greater London TW8 8FN
£1,800 pcm



PROPERTY DESCRIPTION

AVAILABLE 10th MAY...

A stunning one bedroom luxury apartment with balcony on the Grand Union Canal and River Brent in the award winning waterside Brentford Lock West development.

The property has been finished to the highest standard and consists of a fully fitted kitchen, large open-plan reception room with oak wooden flooring, large balcony.

The apartment also benefits from ample storage and lift access, tiled bathroom, air filtration system with heat recovery and fibre optic broadband.

Copland Court is a part of the desirable Brentford Lock West development, a stylish and tranquil location overlooking the Grand Union Canal and the picturesque Brentford Lock. This sustainable development is moments away from Brentford high street and can easily access the selection of shops, cafes and restaurants the area has to offer. In addition, residents can take advantage of the communal landscaped gardens and rooftop allotments. Commuters are able to utilise a number of transport links both in and out of London.

POINTS OF INTEREST

- SPACIOUS ONE BEDROOM APARTMENT
- LARGE BALCONY
- AWARD WINNING WATERSIDE DEVELOPMENT
- UNDERGROUND BIKE STORAGE
- EXCELLENT TRANSPORT LINKS
- WELL DESIGNED
- WELL PRESENTED THROUGHOUT
- EASY ACCESS TO BRENTFORD HIGH STREET

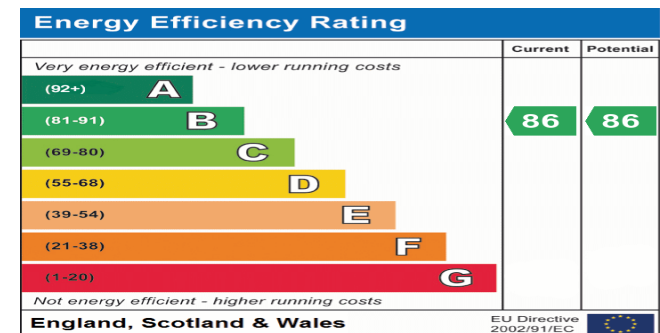

Copland Court Durham Wharf Drive TW8 8FN

Approx. Gross Internal Area = 56.9 sq m / 612 sq ft

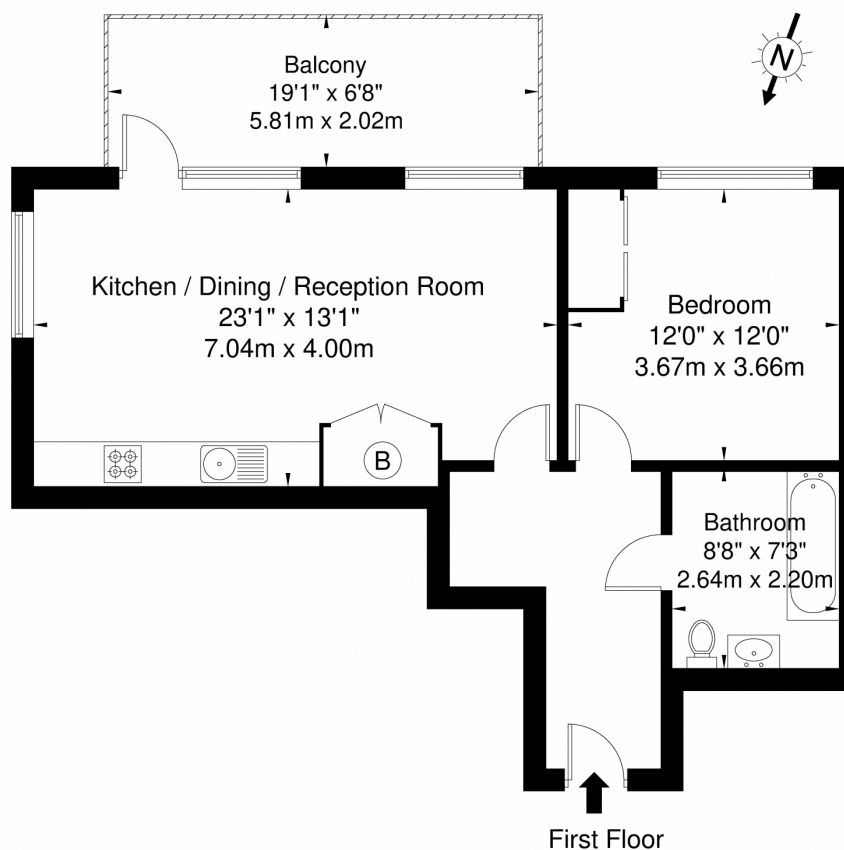

Ref

Copyright **BLEU
PLAN**

The Floor plan is not to scale and measurements and areas shown are approximate and therefore should be used for illustrative purposes only. The plan has been prepared in accordance with the RICS code of Measuring Practice and whilst we have confidence in the information produced it must not be relied on. If there is any aspect of particular importance, you should carry out or commission your own inspection of the property.

Copyright @ BLEUPLAN