

Sales: 020 8452 7000
Lettings: 020 8900 2121
Email: wg@danielsestateagents.co.uk
www.danielsestateagents.co.uk

daniels
danielsestateagents.co.uk



Litchfield Gardens

Willesden, London, NW10 2LN

£550,000



Floor Plan

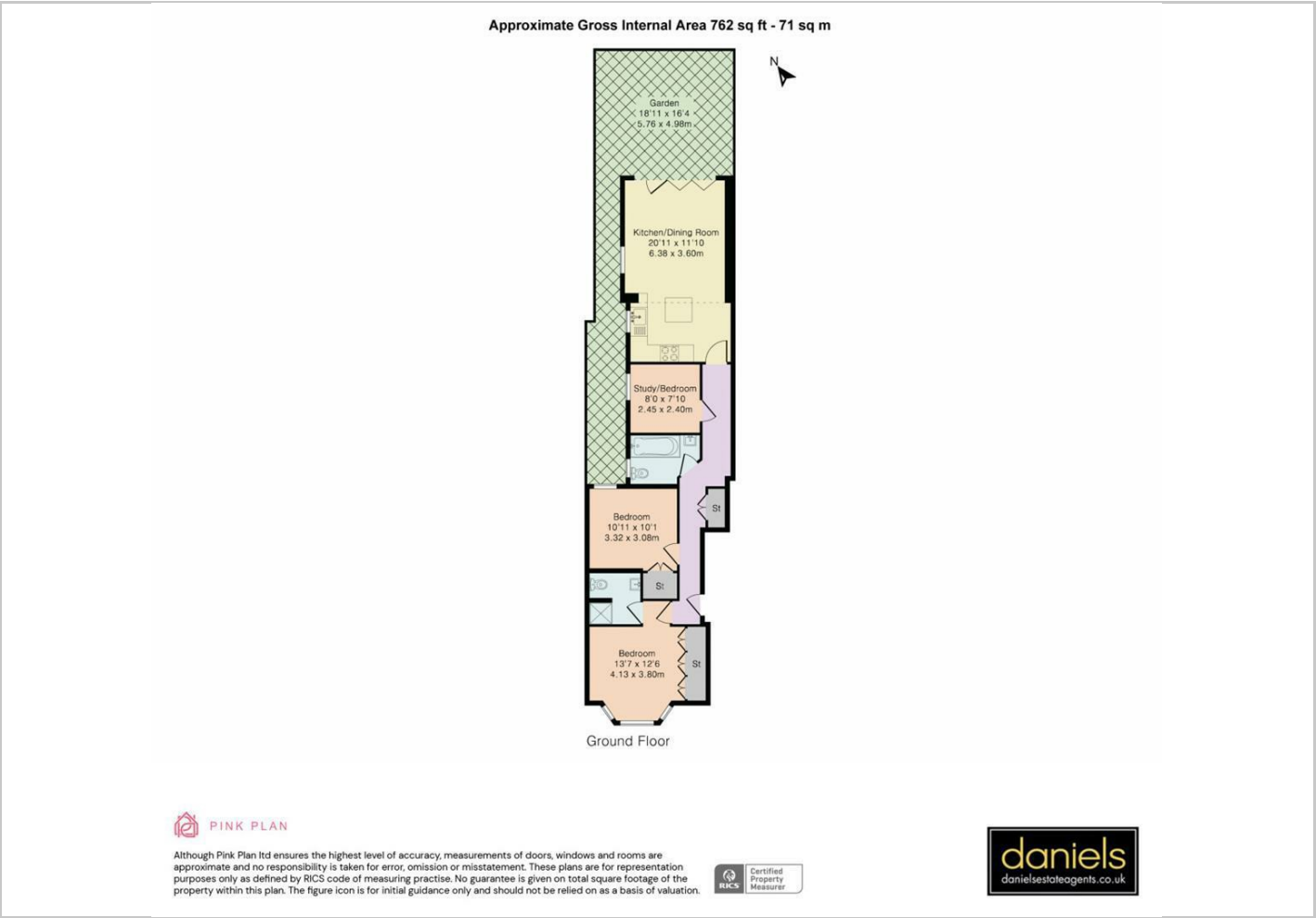

- Immaculately Presented ■ Open Plan Kitchen-Living Throughout
- Two Bathrooms ■ No Upper Chain
- 0.7 Miles to Willesden Green Station ■ Private Rear Garden

Energy Efficiency Graph

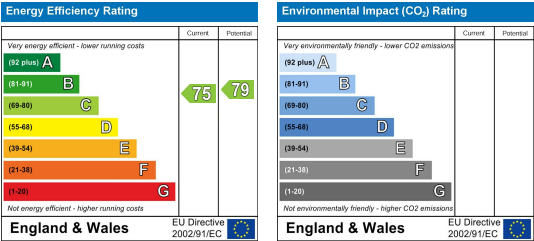

These particulars, whilst believed to be accurate are set out as a general outline only for guidance and do not constitute any part of an offer or contract. Intending purchasers should not rely on them as statements of representation of fact, but must satisfy themselves by inspection or otherwise as to their accuracy. No person in this firms employment has the authority to make or give any representation or warranty in respect of the property.

Sudbury

35 Court Parade, Sudbury
Middlesex HA0 3HS
Sales 020 8904 4888
Lettings 020 8452 7999
E sudbury@danielsestateagents.co.uk

Wembley

438 High Road, Wembley
Middlesex HA9 6AH
Sales 020 8900 2811
Lettings 020 8452 7999
E wembley@danielsestateagents.co.uk

Neasden

352 Neasden Lane, Neasden
London NW10 0AD
Sales 020 8452 7000
Lettings 020 8452 7999
E neasden@danielsestateagents.co.uk

Willessden Green

33 Walm Lane, Willessden Green
London NW2 5SH
Sales 020 8452 7000
Lettings 020 8452 7999
E willessdengreen@danielsestateagents.co.uk

Kensal Rise

77 Chamberlayne Road, Kensal Rise
London NW10 3ND
Sales 020 8969 5999
Lettings 020 8969 5999
E kensalrise@danielsestateagents.co.uk