



Hanover Road, London, NW10 3DJ

£4,500



Floor Plan

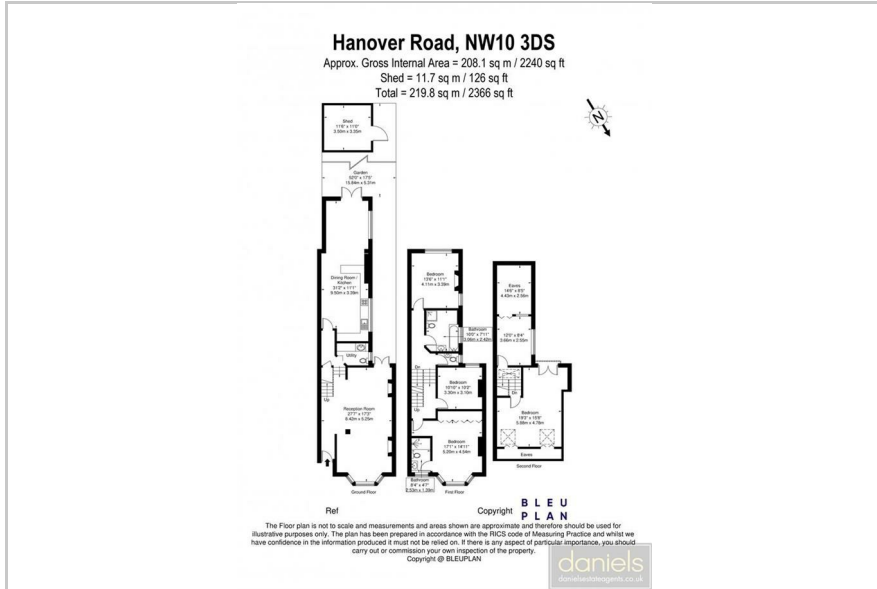

Area Map

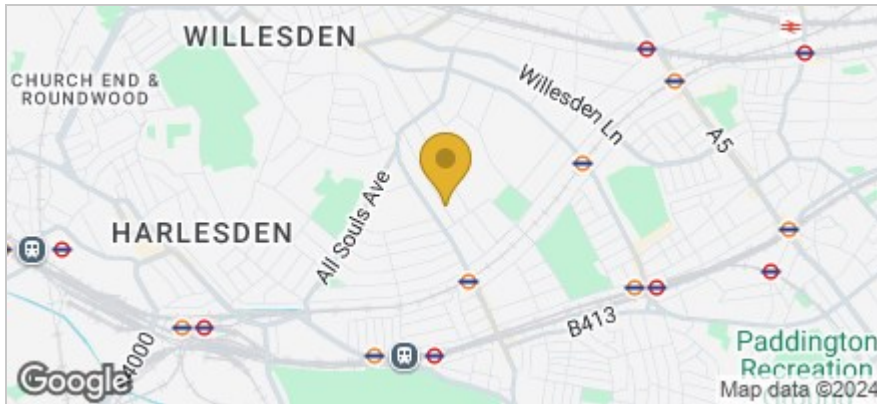

These particulars, whilst believed to be accurate are set out as a general outline only for guidance and do not constitute any part of an offer or contract. Intending purchasers should not rely on them as statements of representation of fact, but must satisfy themselves by inspection or otherwise as to their accuracy. No person in this firm's employment has the authority to make or give any representation or warranty in respect of the property.

Accommodation

- 5 BEDROOM/3 BATHROOM FAMILY HOME SET OVER 3 FLOORS
- KITCHEN DINER
- RECENTLY REDECORATED
- BEAUTIFUL WEST FACING PRIVATE GARDEN
- OFF STREET PARKING
- RESIDENTIAL STREET
- IDEALLY SITUATED
- QUEENS PARK WITHIN WALKING DISTANCE

Viewing

Please contact our Daniels, Willesden Green Office on 020 8452 7000 if you wish to arrange a viewing appointment for this property or require further information.

Energy Efficiency Graph

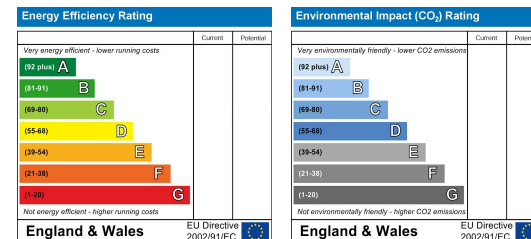

Sudbury

35 Court Parade, Sudbury
 Middlesex HA0 3HS

Sales 020 8904 4888
 Lettings 020 8452 7999
 E sudbury@danielsestateagents.co.uk

Wembley

438 High Road, Wembley
 Middlesex HA9 6AH

Sales 020 8900 2811
 Lettings 020 8452 7999
 E wembley@danielsestateagents.co.uk

Neasden

352 Neasden Lane, Neasden
 London NW10 0AD

Sales 020 8452 7000
 Lettings 020 8452 7999
 E neasden@danielsestateagents.co.uk

Willesden Green

33 Walm Lane, Willesden Green
 London NW2 5SH

Sales 020 8452 7000
 Lettings 020 8452 7999
 E willesdengreen@danielsestateagents.co.uk

Kensal Rise

77 Chamberlayne Road, Kensal Rise
 London NW10 3ND

Sales 020 8969 5999
 Lettings 020 8969 5999
 E kensalrise@danielsestateagents.co.uk